

System **KURRI**[®]

A brand of

MSW GmbH

Mechatronics and
Welding Workshops

*We turn your
waste into handy
and cheap energy !!*



BIBER Wood chipper

+ The Biber crushes your waste wood

+ You win more active space in the production area and a valuable biofuel!

Wood, chipboard and veneered waste will be chipped in granules easy to transport and stock. Briquetting is possible, too.

+ Easy to operate, less personnel cost

Biber works full automatically after setting!

+ The best quality and efficiency

You profit from a specially developed construction and a serial fabrication - 3 types, one price! Biber is a tested austrian high-quality product.

+ Placement, connection, start-up

The Biber can be easily hooked up to a power supply system (network) and connected to a suction with a flexible tube. There is no need in any kind of foundation.

+ Compact and comfortable

The Biber needs only a few space and can be easily placed everywhere.

+ Forceful and reliable

Wood waste will be uniformly chipped in pieces like with a kitchen mixer. On this functional principle nothing can interfere the process. Thus not only uninterrupted operating, but also extremely long Biber's lifetime is achieved. The ready chipped wood pieces will be sucked on the backside of the device.

+ Low-noise

Noise level amounts to 78 dB. It is essentially quieter than in others common woodwork machines.



Technical drawing:

KHZ 200/7,5 kw for normal woodwork waste
KHZ 200/11 kw for softwood in big pieces
KHZ 200/15 kw for hardwood to recommend

Total weight: about 500 kg
Chipping speed: 100 - 200 kg/h
Granules: 3 - 10 mm Ø x 30 mm (=outcome)

Wood waste size: till 120 x 120 mm
Cross-section till about 500 mm length

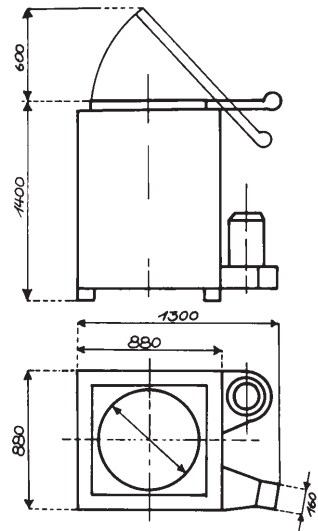

= Your profit

SystemKURRI®

A brand of
MSW GmbH
Mechatronics and
Welding Workshops

System Kurri is to be represented by:

Dr. Alexander Schaerf Strasse 12
A-2700 Wiener Neustadt
Austria

Tel: +43 2622 238 650
Fax: +43 2622 238 653
office@kurri.com

www.kurri.com